

CVRSL TIME TRIAL 2011
HOSTED BY PORTERVILLE NEPTUNITES SWIM TEAM

DATE: Saturday July 16, 2011

TIME: Meet begins at 9:00AM

PLACE: Monache High School 960 N. Newcomb, Porterville

RULES INFORMATION

1. The CVRSL and USS Rules will govern the meet.
2. The meet is pre-seeded with timed finals from slowest to fastest heats.
3. All scratches must be in to the Clerk of the Court by 8:00am. Only pre-registered coaches can scratch a swimmer or make relay changes. Coaches meeting at 8:40am by the Starter. Coaches will receive computer generated relay cards for relay changes and alternates. Relay cards must be submitted to the computer table prior to the beginning of the meet.
4. Any swimmer who misses one of their scheduled events will be scratched from their next individual event.
5. Each team is responsible for providing two Stroke and Turn Officials. All Officials are to meet with the Meet Referee at 8:20am in the staging area.
6. Coaches will receive their Meet packet when they check in. Included in the team packet will be the coaches' programs, badges and meal tickets.
7. Team warm-ups, must be supervised by team coaches.
8. Smoking and the use of tobacco products are strictly prohibited anywhere on the school campus.
9. Any concerns or questions about results are to be entered in writing at the computer table within 30 minutes after delivery of the DQ Slip. The Head Coach is the only person from the team who can submit questions (not assistant coaches, swimmers or parents).
10. Qualifying standards: Swimmers must have competed in at least three dual meets during the season to be eligible. Swimmers may swim in up to three individual events after achieving a qualifying time in those events. Swimmers may also swim in two relays.
11. Award: Medals will be given for 1st through 3rd place. Ribbons will be given for 4th through 24th places for individual events and 4th through 14th place for all relays. Participation ribbons will be awarded to all swimmers placing above 24th place. All teams will pay for awards received by their swimmers at the conclusion of the meet.
12. Only those swimmers who have been processed through the staging area will be allowed on the deck.
13. All swimmers are asked to wait in the grassy area EAST of the pool area in each team's designated area. Teams are encouraged to bring shades, canopies and tents to provide adequate shade for their swimmers. A PA

- System will be set up to announce upcoming events plus the leagues LED Event Board will be visible to the camp area. You may setup your camp area on Friday evening between 6-8pm. Keep in mind that the area is not fully secured, so do so at your own risk.
14. No vehicles of any kind will be allowed on the grass. Please do not block any vehicular fire lanes.
 15. A 30-minute lunch break will be held after event #46 (IM). The pool will be opened to all swimmers for warm-ups at this time with each teams' coaches providing supervision to swimmers.
 16. Programs are available at a cost of \$5.00 each or \$4.00 presale. T-shirts are available on a first-come first-serve basis, and will list all swimmers names that are entered by the July 10th date for \$15 and \$13 presale. The attachment with this email is for presale t-shirts and meet info. Please contact Wendy Lopez at jwjslopez@hotmail.com if you have any questions regarding t-shirts. Your order will be ready to be picked up the morning of the meet, by a representative of your team with a team check.
 17. As a courtesy to others, ice chests will not be allowed in the bleacher area. The East and Southeast spectator's areas will be designated as a "No Camping Zone". It is designated for spectator's to walk up, watch an event, and then clear the area for other spectators. We find most spectators have certain races that they wish to watch and then return to their team area. This is a "Limited Time" area that will allow spectators to view their swimmers' race.
 18. Refreshments will be provided to all working officials, starters, timers and coaches.
 19. A fully stocked concession stand will be available. Pancakes, breakfast burritos, oatmeal, bagels, donuts, hamburgers, drinks, Jamba Juice, snow cones, nachos, fritto boats, etc...
 20. We will be very strict about keeping the competition area free of any excess people. Only coaches with identification badges can gain entrance to the northeast gate. Swimmers will only enter the competition area after being staged at the northeast gate.
 21. By the end of Time Trials teams must submit a list of swimmers that are not able to attend the All Star Finals.

****All entries must be submitted to division3@cvrsl.org by 5pm this Sunday, July 10, 2011. In order to add new qualifiers from Tuesday, July 12, 2011 meets, send late entries to the above email by noon on Wednesday, July 13, 2011. To scratch swimmers or make relay changes contact John Acencio at jface@charter.net ****

Questions? Call Rick Conway: 559-783-4155

TIMING RESPONSIBILITIES

AM SHIFT

LANES

1. Coalinga
2. Visalia Seahawks
3. Visalia Waves
4. Visalia Seahawks
5. Lindsay
6. Exeter
7. Woodlake
8. Fowler

PM SHIFT

LANES

1. Lindsay
2. Visalia Waves
3. Visalia Waves
4. Coalinga
5. Fowler
6. Exeter
7. Woodlake
8. Exeter

Each team is responsible for getting their volunteers to their designated lanes and providing relief timers/records (3 per lane).

WARM UP SCHEDULE

Diving lanes are determined by each team under their coach's supervision.

- 7:30 – 7:45 Lanes 1-3 Lindsay
- 7:30 – 7:45 Lanes 4-8 Porterville
- 7:45 – 8:00 Lanes 1-3 Woodlake
- 7:45 – 8:00 Lanes 4-8 Exeter
- 8:00 – 8:15 Lanes 1-4 Visalia Seahawks
- 8:00 – 8:15 Lanes 5-8 Visalia Waves
- 8:15 – 8:30 Lanes 1-4 Fowler
- 8:15 – 8:30 Lanes 5-8 Coalinga

8:30 – 8:45 & Lunch Time – No diving during these times.

- Lane 1 – Coalinga
- Lane 2 – Visalia Seahawks
- Lane 3 – Lindsay
- Lane 4 – Visalia Waves
- Lane 5 – Woodlake
- Lane 6 – Exeter
- Lane 7 – Fowler
- Lane 8 - Neptunites

← Z →

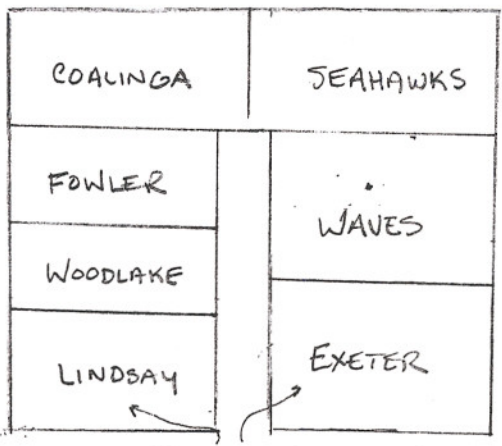

BASEBALL DIAMOND

TEAM CAMP AREAS

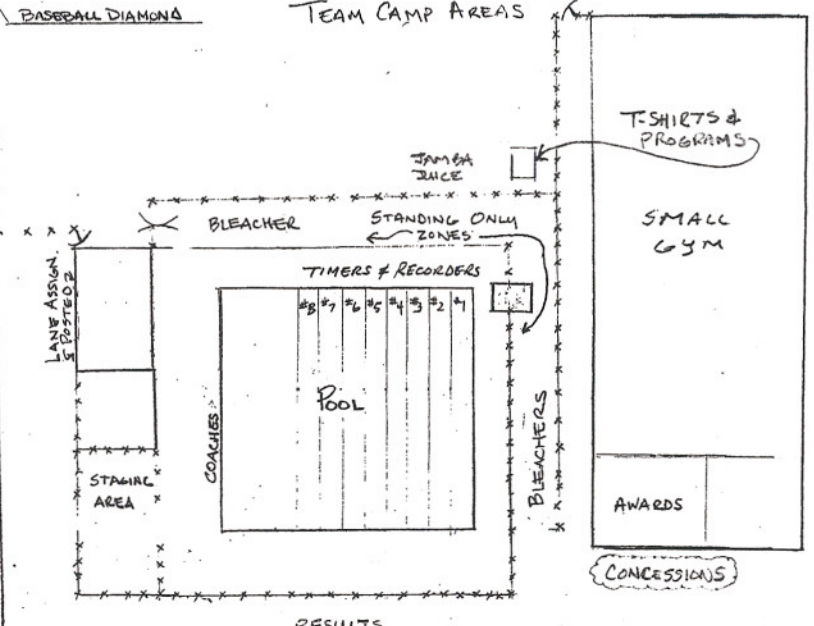
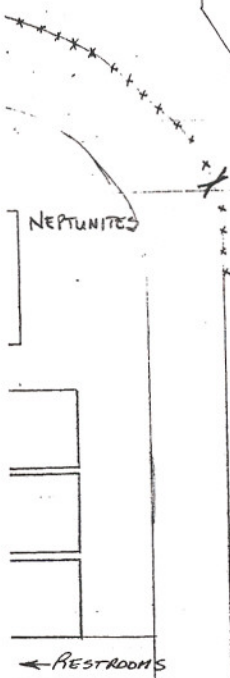

BASKETBALL COURTS

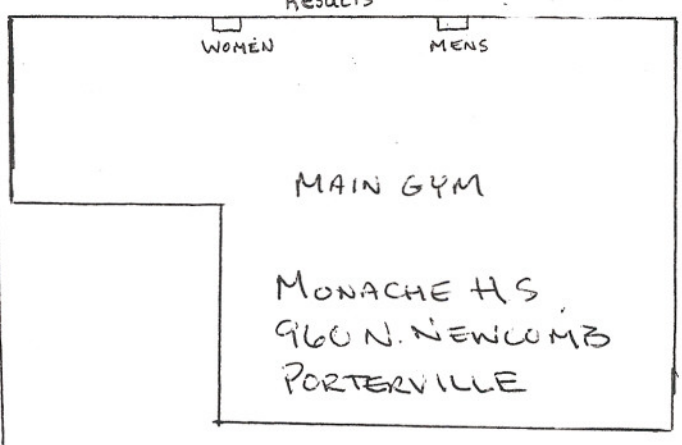

TENNIS COURTS

HENDERSON AVENUE

PARKING

NEWCOMB STREET

TEAM CAMP AREA

SWIM MEET FLOW CHART

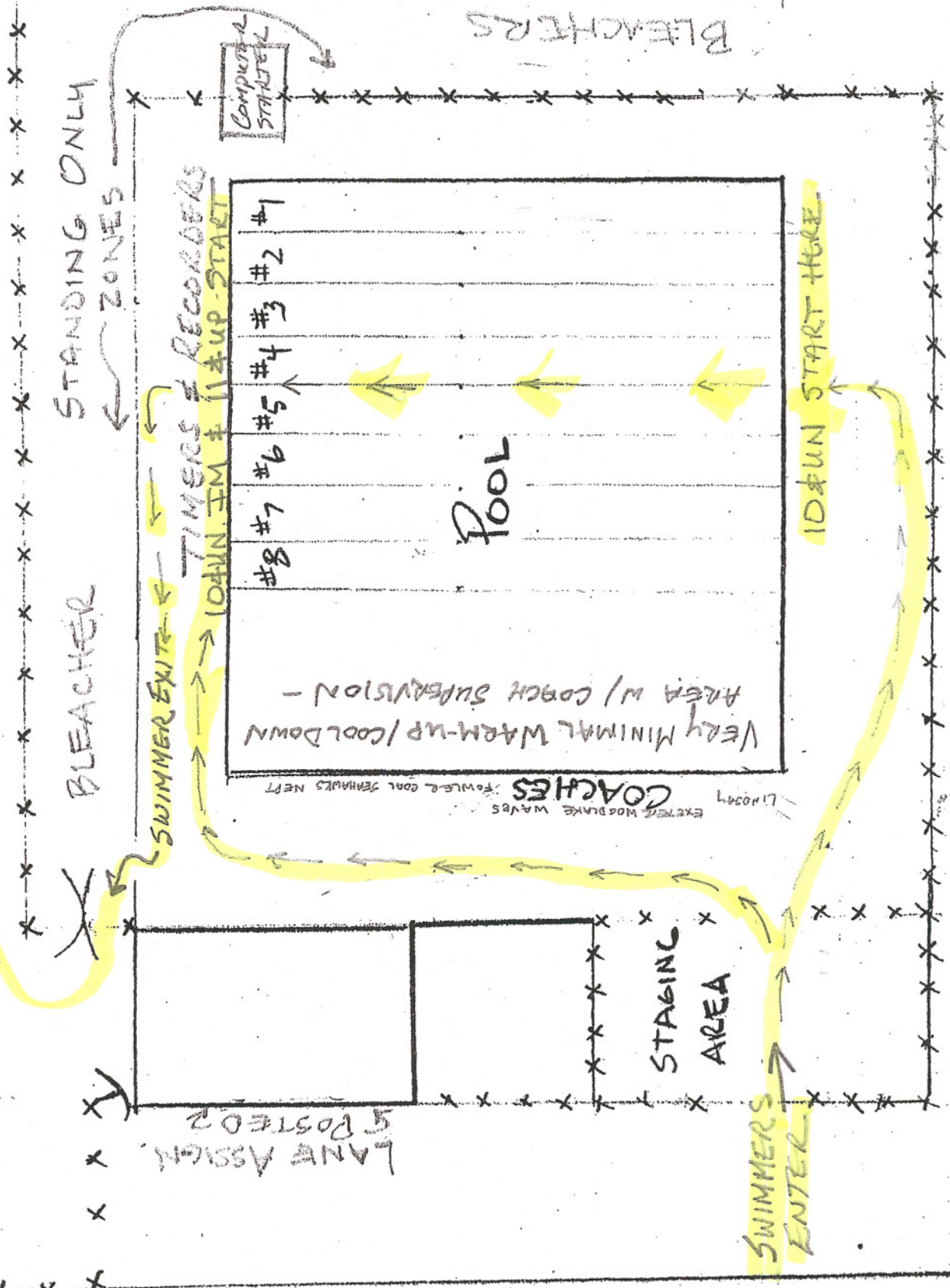

BLEACHERS

STANDING ONLY ZONES

COMPUTER STATION

LANE ASSIGN. & POSTED

VERY MINIMAL WARM-UP/COOL DOWN - AREA W/ COACH SUPERVISION

COACHES

TIMER'S & RECORDERS

10 MIN START HERE

POOL

STAGING AREA

SWIMMERS ENTER

10 MIN START HERE

RESULTS POSTED

RESTROOMS

RESTROOMS

COMMISSIONS